

T5 Fluorescent System



SlimLamp - T5 / Slick - T5
Surface mounted fluorescent system

Features

- Housing made in extruded aluminium.
- End caps made of heat resistance thermoplastic.
- Diffuser made in prismatic polycarbonate.
- Integrated electronic control gear.
- Designed and manufactured to comply with European standard EN 60598.

Applications

- Slick-T5 is of slim smooth elegant profile.
- Designed to suit the under shelf and cove light applications with the advantages of being available in different lengths.
- Can be linked together by mean of special connectors.
- The lamp life is up to 10.000 hours making it energy saving advanced technology luminaire.

Small Size

SlimLamp - T5



14W
21W
28W
35W

Slick - T5



14W
21W
28W
35W



DimSlim - T5
Surface mounted dimmable fluorescent system

Features

- End caps made of heat resistance thermoplastic.
- Diffuser made in prismatic polycarbonate.
- Integrated electronic dimmable control gear.
- Designed and manufactured to comply with European standard EN 60598.

Applications

- DimSlim is the most undersized dimmable fluorescent lamp in the world. It now offers designers the option of providing a fully dimmable fluorescent lighting system in the smallest spaces.
- Controlled by a simple wall mounted controller, 2220 or 2221 (2220 intensity control only/ 2221 intensity and color temp. Control, performing a series of combinations/scenes at your pleasure.

Dimmable

DimSlim - T5



14W
21W
28W
35W



HP Slim - T5
Surface mounted fluorescent system

Features

- Twice light output than Slimlamp in the same length.
- End caps made of heat resistance thermoplastic.
- Diffuser made in prismatic polycarbonate.
- Integrated electronic control gear.
- Designed and manufactured to comply with European standard EN 60598.

Applications

- Double intensity of light and slenderized structure maximize the effect of indirect lighting in cove, valance, display cases.
- Can be linked together by mean of special connectors.
- The lamp life is up to 10.000 hours making it energy saving advanced technology luminaire.

Twice Output

HP Slim - T5



24W
39W
54W



SlimLine - T5 / DimSlimLine - T5
Surface mounted fluorescent system

Features

- Exclusively designed lamp in special shape.
- End caps made of heat resistance thermoplastic.
- Integrated electronic control gear.
- Designed and manufactured to comply with European standard EN 60598.

Applications

- Dark zone between fixtures is covered by the special shape lamp to enjoy continuous lighting effect with SlimLine.
- Can be linked together by mean of special connectors.
- The lamp life is up to 10.000 hours making it energy saving advanced technology luminaire.

Dark Zone Free

SlimLine - T5 / DimSlimLine - T5



14W
21W
28W
24W
39W
54W

DimSlimLine-T5



DimSlimLine-T5

4030	14W T5	
4031	21W T5	
4032	28W T5	

DimSlimLine-T5 (HP)

4035	24W T5	
4036	39W T5	
4037	54W T5	

Newly developed lamp is special shape included.

IP20

Dark Zone Free

ART.	A	B	Max. Linkage per controller / translator
4030	580	500	20
4031	880	800	19
4032	1180	1100	14

4035	580	500	16
4036	880	800	10
4037	1180	1100	7

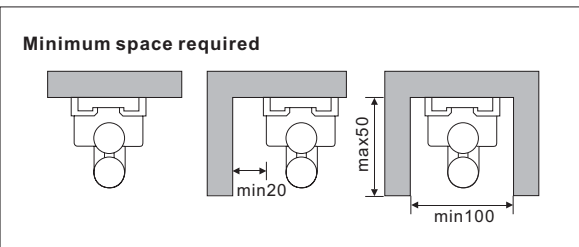
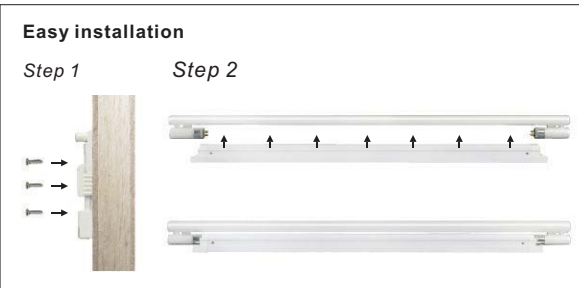
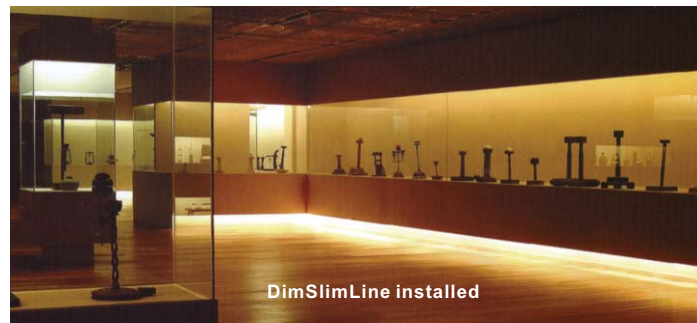
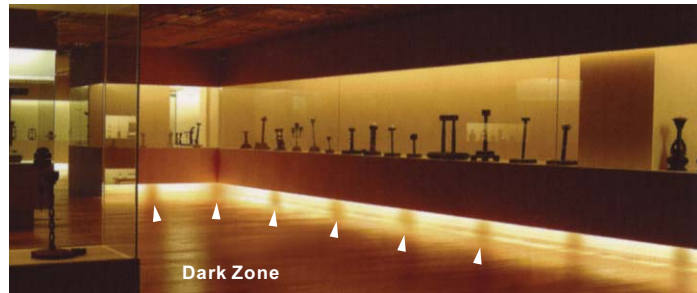
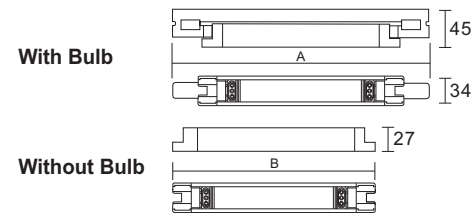

Dimmable effect



5%

50%

100%

Accessories



Dimming Controller (Brightness & Mood)

2580

- 2 Channels
- Max. Connection: 10 pcs of DimSlimLine per channel, up to 350W regardless of channel
- Control range: 4 scenes memorized.
- Input power: AC90~240V
- Frequency: 50/60Hz
- Output protocol: PWM 400Hz
- Dimension: (W122 x H122 x D45)mm



DALI/DSI/DMX to DimSlim PWM Translator

2306

- Interface DimSlim PWM with any other DALI/DSI/DMX manufactured control proprietary system.
- A single translator can handle a total of 3,500 lamp watts
- 4 independent PWM output signals for DimSlim
- Maximum connecting load for individual output is 10 amps/1750 lamp watts per circuit, or 50 fixtures per channel.

Availability:

- Translates standard DALI 4 device protocol with DALI
- Translates standard DMX 512 protocol
- Translates DSI protocol
- Volt: AC196~264V
- Frequency: 50/60Hz
- Current: 20 amp - 4mm² terminals
- Mechanical fixing: DIN rail clip lock
- Dimension: (H86 x W209 x D66)mm



Dimming Controller (Brightness)

2220

- 1 Channel
- Max. Connection: 10 pcs of DimSlim per channel
- Control range: 1~14 level of intensity
- Input power: AC90~240V
- Frequency: 50/60Hz
- Output protocol: PWM 400Hz
- Dimension: (W70 x H120 x D38)mm



Dimming Controller Back boxes for 2220

2588

- Metal Backbox for recessing into walls.
- Dimension: 102 x 53 x 44(mm)



Booster

2307

2220 & 2221 is able to connect maximum 10pcs of DimSlim per channel. But Booster remarkably extends connecting capability. Link Booster at the 10th DimSlim from 2220 or 2221 and then 20pcs more fixtures can be connected.



0-10V/1-10V to PWM Translator

2309

- Rated Input: AC 100~24V, 50/60Hz
- Channel: 2CH
- Maximum connection: DimSlim 10pcs / ch
- Signal: Input: 0~10V/1~10V
- Output: PWM
- Dimension: 150 x 58 x 35(mm)



Direct Connector

2296



Vertical Power Cord

Without plug

2586 Length: 1800



Flexible Connector

2585 Length: 150

2358 Length: 300

2501 Length: 600

2502 Length: 1200

2503 Length: 1800

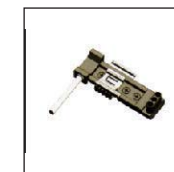

Horizontal Power Cord

Without plug

2587 Length: 1800



Power Cord

Without plug

2356 Length: 1800

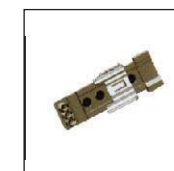

Protecting Cap

2297

