



A range of luminaires manufactured from die-cast aluminium with a semi-spherical or cone shaped diffuser in frosted glass. The luminaires are designed for mounting on extruded aluminium post or wall mounted. A variety of mounting arms and accessories are offered for different mounting positions and angles, single or twin mounting on posts up to 4m height maximum. Both KONOS PARK and GLOBUS PARK are offered in two different sizes and are suitable for HID lamp sources. They are ideal for pedestrian walkways and residential areas.

- Body and frame made of die-cast aluminium with chromium phosphate pretreatment and polyester powder coating, complying with the IEC 68-2-52 and ASTM B117/90 Standards, ensuring UV stabilisation combined with highest resistance to heat and atmospherical condition.
- Ice etched glass diffuser, conical shape.
- Aluminium reflector.
- Polymer gasket.
- Pole or wall mount.
- Including capacitor for power factor correction.
- 1x70W SE version is supplied for lamp with built-in ignitor.



### KONOS PARK 38

Lampholder	W	Ilcos	*K	Optic	Colour	Class	Wiring	EEL =	Cosp ≥ 0,9	Code	Notes
E27	70	SE/I		C	96	I	CR			• <b>05261096</b>	△
E27	100	ME		C	96	I	CR			• <b>05261296</b>	

### KONOS PARK 50

Lampholder	W	Ilcos	*K	Optic	Colour	Class	Wiring	EEL =	Cosp ≥ 0,9	Code	Notes
E27	150	ME		C	96	I	CRL			• <b>07024896</b>	⚡
E40	150	SE		C	96	I	CR			• <b>05261596</b>	

- △ For lamps with integral ignitor.
- ⚡ Fittings supplied complete with lamp.

				<b>IK 06 1J</b>	<b>KONOS PARK 38</b>  max 7 kg	<b>KONOS PARK 50</b>  max 11,8 kg						
<b>CLASS I</b>			<b>96</b>	<b>IP 65</b>						<b>ME</b> 100-150W HQI-E CDO-ET	<b>SE</b> 150W NAV-E/SON	<b>SE/I</b> 70W NAV-E/SON △
<b>KONOS PARK 38</b>				<b>KONOS PARK 50</b>								

A range of luminaires manufactured from die-cast aluminium with a semi-spherical or cone shaped diffuser in frosted glass. The luminaires are designed for mounting on extruded aluminium post or wall mounted. A variety of mounting arms and accessories are offered for different mounting positions and angles, single or twin mounting on posts up to 4m height maximum. Both KONOS PARK and GLOBUS PARK are offered in two different sizes and are suitable for HID lamp sources. They are ideal for pedestrian walkways and residential areas.

- Body and frame made of die-cast aluminium with chromium phosphate pretreatment and polyester powder coating, complying with the IEC 68-2-52 and ASTM B117/90 Standards, ensuring UV stabilisation combined with highest resistance to heat and atmospherical condition.
- Ice etched glass diffuser, conical shape.
- Aluminium reflector.
- Polymer gasket.
- Pole or wall mount.
- Including capacitor for power factor correction.
- 1x70W SE version is supplied for lamp with built-in ignitor.

# GLOBUS PARK

design Roberto Fiorato



## GLOBUS PARK 38

Lampholder	W	Ilcos	*K	Optic	Colour	Class	Wiring	EEL =	Cosp ≥ 0,9	Code	Notes
E27	70	SE/I		C	96	I	CR			• <b>05261796</b>	△
E27	100	ME		C	96	I	CR			• <b>05261996</b>	

## GLOBUS PARK 50

Lampholder	W	Ilcos	*K	Optic	Colour	Class	Wiring	EEL =	Cosp ≥ 0,9	Code	Notes
E27	150	ME		C	96	I	CRL			• <b>07024996</b>	💡
E40	150	SE		C	96	I	CR			• <b>05262296</b>	

△ For lamps with integral ignitor.

💡 Fittings supplied complete with lamp.

			<b>GLOBUS PARK 38</b>	<b>IK 07</b>		<b>GLOBUS PARK 50</b>	<b>IK 08</b>					
				<b>2J</b>	max 7,5 kg		<b>5J</b>	max 13,6 kg				

<b>CLASS I</b>			<b>96</b>	<b>IP 65</b>							<b>ME</b> 100-150W HQ-E CDO-ET	<b>SE</b> 150W NAV-E/SON	<b>SE/I</b> 70W NAV-E/SON △
----------------	--	--	-----------	--------------	--	--	--	--	--	--	-----------------------------------------	--------------------------------	--------------------------------------

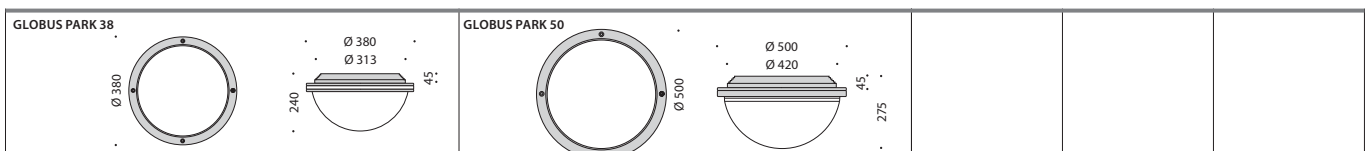

## ACCESSORIES

Code	Denomination	Colour	Description
14104896	A0492/2	96	Oval pole 200 FT.
14104996	A0492/2,5	96	Oval pole 250 FT.
14105096	A0492/3	96	Oval pole 300 FT.
14105196	A0492/2+0,5	96	Oval pole 200+50 INT.
14105296	A0492/2,5+0,5	96	Oval pole 250+50 INT.
14105396	A0492/3+0,5	96	Oval pole 300+50 INT.
14105496	A0493	96	Fixing arm plate (single)
14105596	A0493/BI	96	Fixing arm plate (double)
14105696	A0494/38-1	96	Short horizontal fixing arm 38
14105796	A0494/38-2	96	Long horizontal fixing arm 38
14105896	A0494/38-3	96	Short angled arm 38
14105996	A0494/38-4	96	Long angled arm 38
14106096	A0495/50-1	96	Short horizontal fixing arm 50
14106196	A0495/50-2	96	Long horizontal fixing arm 50
14106296	A0495/50-3	96	Short angled arm 50
14106396	A0495/50-4	96	Long angled arm K50-G50
14106496	A0496	96	Bracket
14106596	A0497	96	Corner bracket
14106696	A0498	96	Flange plate oval pole FT.
14106720	A0499		Anti sink plate oval INT. Pole
14106896	A0500	96	Base plate cover ov. Pole
14099404	A0478		Flange plate with fixing root
14099320	A0477		Fixing rod Ø 18 X 400

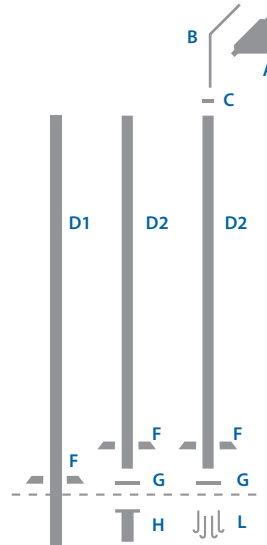

### COMPLETE UNIT

- 1A+1B+1C+1D1+1E+1F = 6 codes
- 2A+1B+2C+1D1+1E+1F = 8 codes
- 1A+1B+1C+1D2+1F+1G+1H = 7 codes
- 2A+1B+2C+1D2+1F+1G+1H = 9 codes
- 1A+1B+1C+1D2+1F+1G+4L = 10 codes
- 2A+1B+2C+1D2+1F+1G+4L = 12 codes

ELEMENTEN	
A	luminaire
B	arm
C	fixing arm plate
D1	post INT
D2	post FT
E	anti sink plate
F	base plate cover
G	flange plate
H	flange plate with fixing root
L	fixing rod

14105896

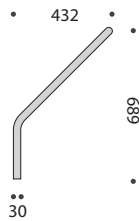

14106296

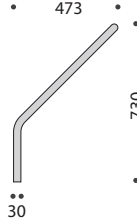

14105696



14106096

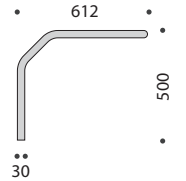

14105796

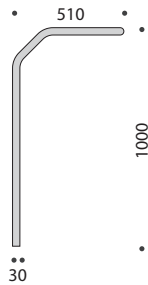

14106196

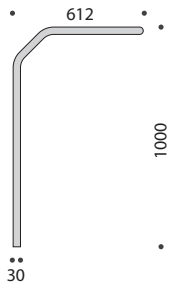

14106396

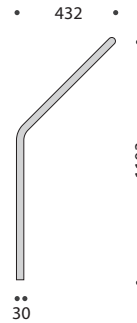

14106396

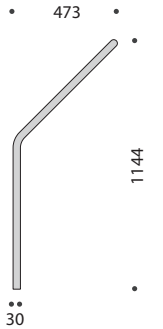

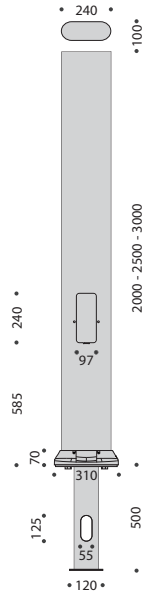
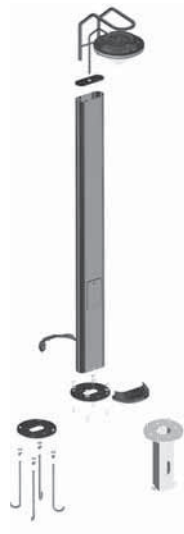

14104896  
14104996  
14105096

14106896

14106696

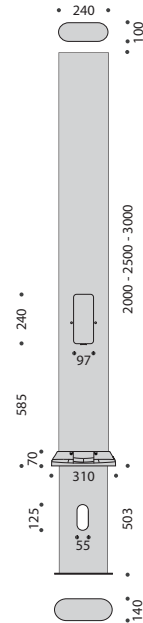
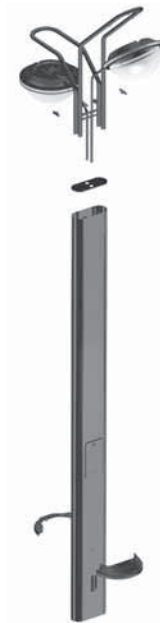

14105196  
14105296  
14105396

14106896

14106720

14099404

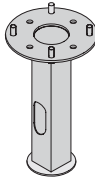

14106696

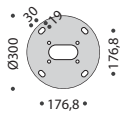

14099320



14106496

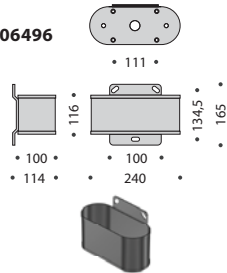

14106596

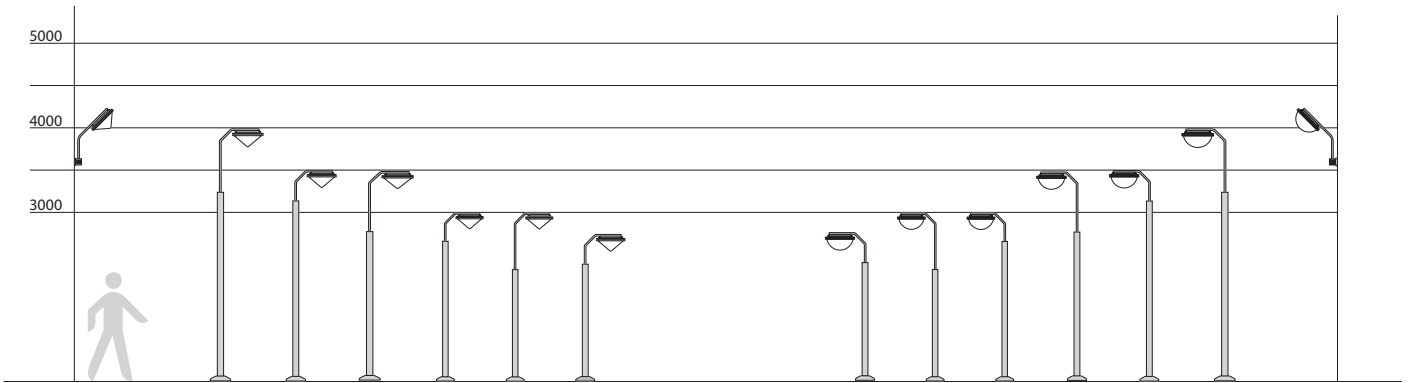
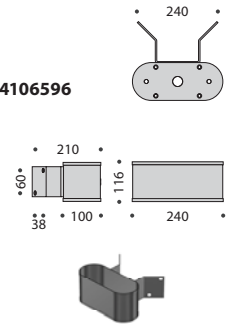

A range of luminaires with body and frame manufactured from die-cast aluminium with a semi-spherical or cone shaped diffuser in frosted glass. Designed for mounting onto a cylindrical post by two symmetrical arms which cradle the fitting. Post are available in 3.0m or 3.5m. The MONOKONOS and MONOGLOBUS fittings are available in two different sizes and are suitable for HID lamps. They are ideal for pedestrian walkways and residential areas.

- Body, frame and arm connector manufactured from die-cast aluminium UNI 5076, phospho-chromate primed and polyester powder coated, complying with IEC 68-2-52 and ASTM B117/90 standards to ensure UV stabilisation combined with good resistance to heat and atmospheric condition.
- Ice etched glass diffuser, conical shape.
- Aluminium reflector UNI 9001/5.
- Polymer gasket.
- Including capacitor for power factor correction.



### MONOKONOS 38

Lampholder	W	Iicos	*K	Optic	Colour	Class	Wiring	EEL =	Cosp ≥ 0,9	Code	Notes
E27	70	SE/I		C	96	I	CR			• <b>05264696</b>	△
E27	100	ME		C	96	I	CR			• <b>05264896</b>	

### MONOKONOS 50

Lampholder	W	Iicos	*K	Optic	Colour	Class	Wiring	EEL =	Cosp ≥ 0,9	Code	Notes
E27	150	ME		C	96	I	CRL			• <b>07025096</b>	💡
E40	150	SE		C	96	I	CR			• <b>05265196</b>	

- △ For lamps with integral ignitor.
- 💡 Fittings supplied complete with lamp.

					<b>IK 06</b> 1J	<b>MONOKONOS 38</b>  max 7 kg	<b>MONOKONOS 50</b>  max 11,8 kg					
--	--	--	--	--	--------------------	-------------------------------------	----------------------------------------	--	--	--	--	--

<b>CLASS I</b>			<b>96</b>	<b>IP 65</b>						<b>ME</b> 100-150W HO-E CDO-ET	<b>SE</b> 150W NAV-E/SON	<b>SE/I</b> 70W NAV-E/SON △
----------------	--	--	-----------	--------------	--	--	--	--	--	-----------------------------------------	--------------------------------	--------------------------------------

<b>MONOKONOS 38</b>			<b>MONOKONOS 50</b>								
---------------------	--	--	---------------------	--	--	--	--	--	--	--	--

A range of luminaires with body and frame manufactured from die-cast aluminium with a semi-spherical or cone shaped diffuser in frosted glass. Designed for mounting onto a cylindrical post by two symmetrical arms which cradle the fitting.

Post are available in 3.0m or 3.5m.

The MONOKONOS and MONOGLOBUS fittings are available in two different sizes and are suitable for HID lamps.

They are ideal for pedestrian walkways and residential areas.

- Body, frame and arm connector manufactured from die-cast aluminium UNI 5076, phospho-chromate primed and polyester powder coated, complying with IEC 68-2-52 and ASTM B117/90 standards to ensure UV stabilisation combined with good resistance to heat and atmospheric condition.
- Ice etched glass diffuser, semispherical shape.
- Aluminium reflector UNI 9001/5.
- Polymer gasket.
- Including capacitor for power factor correction.

# MONOGLOBUS

design Roberto Fiorato



## MONOGLOBUS 38

Lampholder	W	Ilcos	*K	Optic	Colour	Class	Wiring	EEL =	Cosp ≥ 0,9	Code	Notes
E27	70	SE/I		C	96	I	CR			• <b>05265396</b>	△
E27	100	ME		C	96	I	CR			• <b>05265596</b>	

## MONOGLOBUS 50

Lampholder	W	Ilcos	*K	Optic	Colour	Class	Wiring	EEL =	Cosp ≥ 0,9	Code	Notes
E27	150	ME		C	96	I	CRL			• <b>07025196</b>	💡
E40	150	SE		C	96	I	CR			• <b>05265896</b>	

△ For lamps with integral ignitor.

💡 Fittings supplied complete with lamp.

			MONOGLOBUS 38 IK 07 2J	 max 7,5 kg	MONOGLOBUS 50 IK 08 5J	 max 13,6 kg															
--	--	--	------------------------------	----------------	------------------------------	-----------------	--	--	--	--	--	--	--	--	--	--	--	--	--	--	--

CLASS I			96	IP 65									ME 100-150W HOJ-E CDO-ET	SE 150W NAV-E/SON	SE/I 70W NAV-E/SON
---------	--	--	----	-------	--	--	--	--	--	--	--	--	-----------------------------------	-------------------------	--------------------------

MONOGLOBUS 38	 Ø 380	 240 Ø 380 Ø 313 45	MONOGLOBUS 50	 Ø 500	 45 275 Ø 500 Ø 420
---------------	-----------	---------------------------------	---------------	-----------	---------------------------------

## ACCESSORIES

Code	Denomination	Colour	Description
14108496	A0501/2,2	96	Post 220 FT.
14108596	A0501/2,7	96	Post monoKonos/Globus 270 FT.
14108696	A0501/2,2+0,5	96	Post 220 + 50 INT.
14108796	A0502/38	96	Arm 38
14108896	A0502/50	96	Arm 50
14108996	A0503	96	Flange plate
14109020	A0504	96	Fixing rod

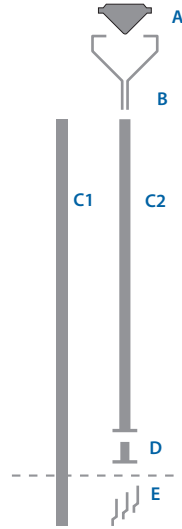

## KOMPLETE UNIT

1A+1B+1C1 = 3 codes  
 1A+1B+1C2+1D+3E = 7 codes

COMPONENTS	
<b>A</b>	luminaire
<b>B</b>	arm
<b>C1</b>	post INT
<b>C2</b>	post FT
<b>D</b>	flange plate
<b>E</b>	fixing rod

