

IP 65

class I

IK06 1J xx3



PLUS

design Roberto Fiorato

Series of wall, bracket, ceiling and post mounted luminaires for indoor and outdoor lighting, in four sizes comprising:

- Die-cast painted aluminium body, trim, visa or split
- Pressed glass diffuser with internal pattern, internally matt
- Aluminium reflector
- EPDM gasket
- Stainless steel locking screws
- 2x26W versions are supplied with two ballasts for individual control of the lamps: requires two separate supply cables
- Magnetic fluorescent versions are provided with low loss ballast
- EM/P are maintained emergency versions
- Ni-Cd 3.6V, 4Ah batteries, 24 hours recharge time
- EM/P versions from 1 to 3 hours also available for different wattages

Leuchtenserie für Wand-, Konsolen-, Decken- und Pollermontage für Innen- und Außenbereiche, in vier Größen, bestehend aus:

- Gehäuse, Ring, Gitter, Blende und Split aus Aluminiumdruckguss.
- Diffusor aus gepresstem Glas, innen mattiert.
- Parabolreflektor aus Aluminium
- EPDM-Dichtung
- Äußere Schrauben aus Edelstahl
- Die Ausführung für eine Bestückung mit 2x26W Lampen ist mit zwei (VVG) Vorschaltgeräte ausgestattet; getrennte Schaltbarkeit möglich
- Die magnetischen Leuchtstofflampenausführungen sind mit verlustarmen Vorschaltgeräten ausgestattet
- EM/3P Ausführung als Normal- und als Notbeleuchtung verwendbar
- Ni-Cd 3,6 V 4 Ah Akkus, drei Stunden Brenndauer, Aufladezeit 24 Stunden
- EM/P Versionen von 1 bis 3 Stunden Brenndauer bei unterschiedlichen Leistungen.



LAMPHOLDER FASSUNG	W	COLOUR CLASS ILCOS	FARBE	KLASSE	COLOUR CLASS KELVIN	COSEFF ≥ 0,9	CODE BESTELLNR.	NOTES BEMERKNG. EURO
-----------------------	---	-----------------------	-------	--------	------------------------	-----------------	--------------------	-------------------------

PLUS OVALE 280

E27	max 1x100w	IAA	WH1	I	•		007615	
E27	max 1x100w	IAA	GR2	I	•		007616	
E27	max 1x100w	IAA	AN2	I	•		007617	

Fluorescent - electronic ballast 220/240V 50/60Hz/Leuchtstofflampen - EVG 220/240V 50/60Hz

2G7	1x9w	FSD	WH1	I	2700	A2÷A3	057627	
2G7	1x9w	FSD	GR2	I	2700	A2÷A3	057628	
2G7	1x9w	FSD	AN2	I	2700	A2÷A3	057629	
G24q-2	1x18w	FSQ	WH1	I	2700	A2÷A3	057615	
G24q-2	1x18w	FSQ	GR2	I	2700	A2÷A3	057616	
G24q-2	1x18w	FSQ	AN2	I	2700	A2÷A3	057617	

IK06 1J xx3

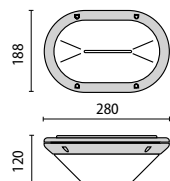

E27	E27	E27	2G7	G24q-2
max 1x100W	1x11W Dulux EL Longlife	1x15W Philips PL-E	1x9W	1x18W

PACKAGE SIZE / VERPACKUNGSMABE

23,5 x 31,5 x 58,5 cm
(master x 4)

DISTANCE BETWEEN FIXING HOLES / BOHRLOCHABSTAND

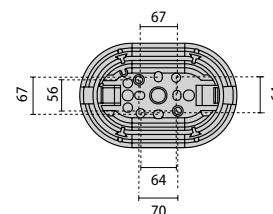

If information about Kelvin degrees is provided, this means that the lamp is included.
Bei Angabe der Grad in Kelvin ist die Lampe eingeschlossen.

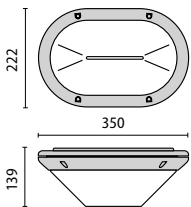

LAMPHOLDER	COLOUR CLASS	COS φ	CODE	NOTES
FASSUNG W	ILCOS FARBE KLASSE	KELVIN ≥ 0,9	EEL	BESTELLNR. BEMERKNG. EURO

PLUS OVALE 350

E27	max 1x150w	IAA	WH1	I	•			007669
E27	max 1x150w	IAA	GR2	I	•			007670
E27	max 1x150w	IAA	AN2	I	•			007671

Fluorescent - electronic ballast 220/240V 50/60Hz/Leuchtstofflampen - EVG 220/240V 50/60Hz

G24q-3	1x26w	FSQ	WH1	I	2700	•	A2	057681
G24q-3	1x26w	FSQ	GR2	I	2700	•	A2	057682
G24q-3	1x26w	FSQ	AN2	I	2700	•	A2	057683
G24q-3	2x26w	FSQ	WH1	I	2700	•	A2	057669
G24q-3	2x26w	FSQ	GR2	I	2700	•	A2	057670
G24q-3	2x26w	FSQ	AN2	I	2700	•	A2	057671

IK06 1J xx3



E27
max 1x150W



E27
1x23W Dulux EL Longlife



E27
1x23W Philips PL-E



G24q-3
1x26W



G24q-3
2x26W

PACKAGE SIZE / VERPACKUNGSMASSE

27 x 39 x 74 cm
(master x 4)

DISTANCE BETWEEN FIXING HOLES / BOHRLOCHABSTAND

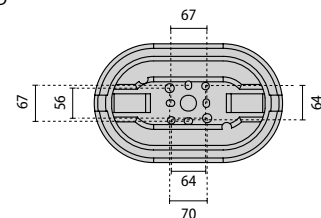

WH1
WHITE
WEISS



GR2
GLOSS METALLIC GREY
GRAU METALLIC, POLIERT



AN2
GLOSS METALLIC ANTHRACITE
ANTHRAZIT METALLIC,
POLIERT

IP 65

class I

IK06 1J xx3



PLUS OVALE 280/G

E27	max 1x100w	IAA	WH1	I	•			007618
E27	max 1x100w	IAA	GR2	I	•			007619
E27	max 1x100w	IAA	AN2	I	•			007620



Fluorescent - electronic ballast 220/240V 50/60Hz/Leuchtstofflampen - EVG 220/240V 50/60Hz

2G7	1x9w	FSD	WH1	I	2700	A2÷A3	057630
2G7	1x9w	FSD	GR2	I	2700	A2÷A3	057631
2G7	1x9w	FSD	AN2	I	2700	A2÷A3	057632
G24q-2	1x18w	FSQ	WH1	I	2700	A2÷A3	057618
G24q-2	1x18w	FSQ	GR2	I	2700	A2÷A3	057619
G24q-2	1x18w	FSQ	AN2	I	2700	A2÷A3	057620

IK06 1J xx3

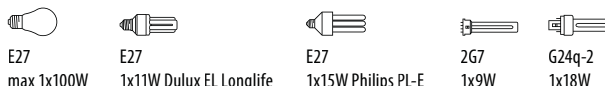
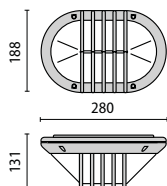

PLUS OVALE 280 VISA

E27	max 1x100w	IAA	WH1	I	•			007621
E27	max 1x100w	IAA	GR2	I	•			007622
E27	max 1x100w	IAA	AN2	I	•			007623



Fluorescent - electronic ballast 220/240V 50/60Hz/Leuchtstofflampen - EVG 220/240V 50/60Hz

G24q-2	1x18w	FSQ	WH1	I	2700	A2÷A3	057621
G24q-2	1x18w	FSQ	GR2	I	2700	A2÷A3	057622
G24q-2	1x18w	FSQ	AN2	I	2700	A2÷A3	057623

IK06 1J xx3

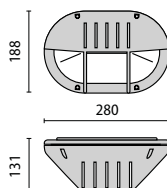

PACKAGE SIZE / VERPACKUNGSMASSE

DISTANCE BETWEEN FIXING HOLES / BOHRLOCHABSTAND

23,5 x 31,5 x 58,5 cm
(master x 4)

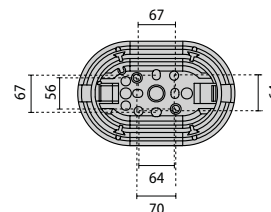

If information about Kelvin degrees is provided, this means that the lamp is included.
Bei Angabe der Grad in Kelvin ist die Lampe eingeschlossen.



LAMPHOLDER	COLOUR CLASS	COS φ		CODE	NOTES
FASSUNG W	ILCOS FARBE KLASSE	KELVIN	≥ 0,9	EEL	BESTELLNR. BEMERKNG. EURO

PLUS OVALE 350/G

E27	max 1x150w	IAA	WH1	I	•		007672
E27	max 1x150w	IAA	GR2	I	•		007673
E27	max 1x150w	IAA	AN2	I	•		007674

Fluorescent - electronic ballast 220/240V 50/60Hz/Leuchtstofflampen - EVG 220/240V 50/60Hz

G24q-3	2x26w	FSQ	WH1	I	2700	• A2	057672
G24q-3	2x26w	FSQ	GR2	I	2700	• A2	057673
G24q-3	2x26w	FSQ	AN2	I	2700	• A2	057674

IK06 1J xx3

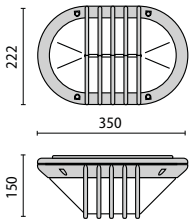

E27
max 1x150W



E27
1x23W Dulux EL Longlife



E27
1x23W Philips PL-E



G24q-3
2x26W

PLUS OVALE 350 VISA

E27	max 1x150w	IAA	WH1	I	•		007675
E27	max 1x150w	IAA	GR2	I	•		007676
E27	max 1x150w	IAA	AN2	I	•		007677

Fluorescent - electronic ballast 220/240V 50/60Hz/Leuchtstofflampen - EVG 220/240V 50/60Hz

G24q-3	2x26w	FSQ	WH1	I	2700	• A2	057675
G24q-3	2x26w	FSQ	GR2	I	2700	• A2	057676
G24q-3	2x26w	FSQ	AN2	I	2700	• A2	057677

IK06 1J xx3

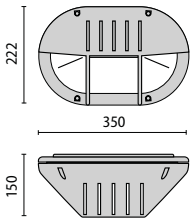

E27
max 1x150W



E27
1x23W Dulux EL Longlife



E27
1x23W Philips PL-E



G24q-3
2x26W

PACKAGE SIZE / VERPACKUNGSMASSE

27 x 39 x 74 cm
(master x 4)

DISTANCE BETWEEN FIXING HOLES / BOHRLOCHABSTAND

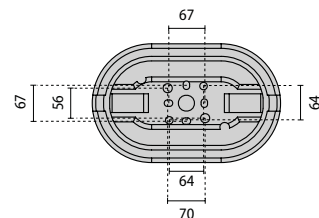

WH1
WHITE
WEISS



GR2
GLOSS METALLIC GREY
GRAU METALLIC, POLIERT



AN2
GLOSS METALLIC ANTHRACITE
ANTHRACIT METALLIC,
POLIERT

PLUS OVALE 280 SPLIT

E27	max 1x100w	IAA	WH1	I	•			007624
E27	max 1x100w	IAA	GR2	I	•			007625
E27	max 1x100w	IAA	AN2	I	•			007626

Fluorescent - electronic ballast 220/240V 50/60Hz/Leuchtstofflampen - EVG 220/240V 50/60Hz

G24q-2	1x18w	FSQ	WH1	I	2700	A2÷A3		057624
G24q-2	1x18w	FSQ	GR2	I	2700	A2÷A3		057625
G24q-2	1x18w	FSQ	AN2	I	2700	A2÷A3		057626



IK06 1J xx3

E27 max 1x100W	E27 1x11W Dulux EL Longlife	E27 1x15W Philips PL-E	G24q-2 1x18W

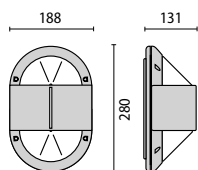

PLUS TONDO 280

E27	max 1x100w	IAA	WH1	I	•			007645
E27	max 1x100w	IAA	GR2	I	•			007646
E27	max 1x100w	IAA	AN2	I	•			007647

Fluorescent - electronic ballast 220/240V 50/60Hz/Leuchtstofflampen - EVG 220/240V 50/60Hz

G24q-2	1x18w	FSQ	WH1	I	2700	A2÷A3		057645
G24q-2	1x18w	FSQ	GR2	I	2700	A2÷A3		057646
G24q-2	1x18w	FSQ	AN2	I	2700	A2÷A3		057647



IK06 1J xx3

E27 max 1x100W	E27 1x14W Osram Dulux EL Facility 1x18W Philips PL-E	G24q-2 1x18W

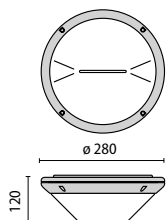

PACKAGE SIZE / VERPACKUNGSMASSE

PLUS OVALE 280
23,5 x 31,5 x 58,5 cm
(master x 4)

PLUS TONDO 280
32 x 32 x 58,5 cm
(master x 4)

DISTANCE BETWEEN FIXING HOLES / BOHRLOCHABSTAND

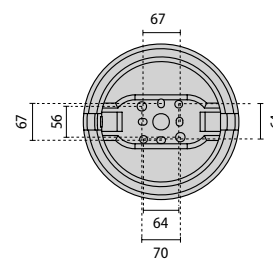
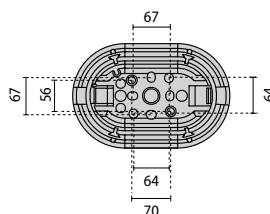

If information about Kelvin degrees is provided, this means that the lamp is included.
Bei Angabe der Grad in Kelvin ist die Lampe eingeschlossen.



LAMPHOLDER	COLOUR CLASS		COS φ		CODE	NOTES	
FASSUNG W	ILCOS	FARBE	KLASSE	KELVIN	≥ 0,9	EEL	BESTELLN.R. BEMERKNG. EURO



PLUS TONDO 350

E27	max 1x150w	IAA	WH1	I	•		007760
E27	max 1x150w	IAA	GR2	I	•		007761
E27	max 1x150w	IAA	AN2	I	•		007762
Discharge - magnetic ballast/Entladungslampe - VVG							
E27	max 1x70w	ME	WH1	I	•	•	007693
E27	max 1x70w	ME	GR2	I	•	•	007694
E27	max 1x70w	ME	AN2	I	•	•	007695
Fluorescent - electronic ballast 220/240V 50/60Hz/Leuchtstofflampen - EVG 220/240V 50/60Hz							
G24q-3	2x26w	FSQ	WH1	I	2700	• A2	057784
G24q-3	2x26w	FSQ	GR2	I	2700	• A2	057785
G24q-3	2x26w	FSQ	AN2	I	2700	• A2	057786



IK06 1J xx3

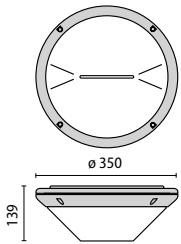

E27
max 1x150W



E27
max 1x70W ME



E27
1x30W Dulux EL Longlife
1x27W Philips PL-E



G24q-3
2x26W



PLUS TONDO 350 EM/2P

Emergency - ferromagnetic ballast/Notbeleuchtung - VVG

G24q-2	2x18w	FSQ	WH1	I	2700	• ≤B2	300720	2
G24q-2	2x18w	FSQ	GR1	I	2700	• ≤B2	300721	2
G24q-2	2x18w	FSQ	AN2	I	2700	• ≤B2	300722	2

PLUS TONDO 350 EM/3P

Emergency - electronic ballast/Notbeleuchtung - EVG



G24q-3	1x26w	FSQ	WH1	I	2700	• A2	3007235	3
G24q-3	1x26w	FSQ	GR1	I	2700	• A2	3007245	3
G24q-3	1x26w	FSQ	AN2	I	2700	• A2	3007255	3
G24q-3	2x26w	FSQ	WH1	I	2700	• A2	3007175	3
G24q-3	2x26w	FSQ	GR1	I	2700	• A2	3007185	3
G24q-3	2x26w	FSQ	AN2	I	2700	• A2	3007195	3

IK06 1J xx3



G24q-2
2x18W



G24q-3
1x26W
2x26W

PACKAGE SIZE / VERPACKUNGSMASSE

PLUS TONDO 350
40,5 x 38,5 x 76,5 cm
(master x 4)

DISTANCE BETWEEN FIXING HOLES / BOHRLOCHABSTAND

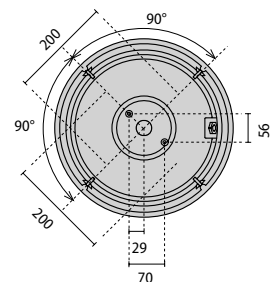

WH1
WHITE
WEISS



GR2
GLOSS METALLIC GREY
GRAU METALLIC, POLIERT



AN2
GLOSS METALLIC ANTHRACITE
ANTHRACIT METALLIC,
POLIERT

2 emergency 2 hours / Sicherheitsleuchten - 2h

3 emergency 3 hours / Sicherheitsleuchten - 3h

IP 65

class I

IK06 1J xx3



PLUS TONDO 280/G

E27	max 1x100w	IAA	WH1	I	•		007648
E27	max 1x100w	IAA	GR2	I	•		007649
E27	max 1x100w	IAA	AN2	I	•		007650



Fluorescent - electronic ballast 220/240V 50/60Hz/Leuchtstofflampen - EVG 220/240V 50/60Hz

G24d-2	1x18w	FSQ	WH1	I	2700	A2÷A3	057648
G24q-2	1x18w	FSQ	GR2	I	2700	A2÷A3	057649
G24q-2	1x18w	FSQ	AN2	I	2700	A2÷A3	057650

IK06 1J xx3

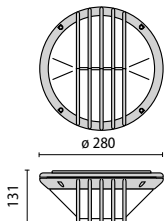

E27
max 1x100W



E27
1x14W Osram Dulux EL Facility
1x18W Philips PL-E



G24q-2
1x18W



PLUS TONDO 280 VISA

E27	max 1x100w	IAA	WH1	I	•		007651
E27	max 1x100w	IAA	GR2	I	•		007652
E27	max 1x100w	IAA	AN2	I	•		007653



Fluorescent - electronic ballast 220/240V 50/60Hz/Leuchtstofflampen - EVG 220/240V 50/60Hz

G24q-2	1x18w	FSQ	WH1	I	2700	A2÷A3	057651
G24q-2	1x18w	FSQ	GR2	I	2700	A2÷A3	057652
G24q-2	1x18w	FSQ	AN2	I	2700	A2÷A3	057653

IK06 1J xx3

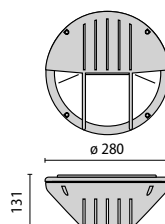

E27
max 1x100W



E27
1x14W Osram Dulux EL Facility
1x18W Philips PL-E



G24q-2
1x18W

PACKAGE SIZE / VERPACKUNGSMASSE

32 x 32 x 58,5 cm
(master x 4)

DISTANCE BETWEEN FIXING HOLES / BOHRLOCHABSTAND

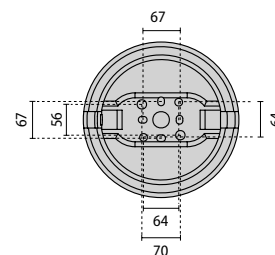

If information about Kelvin degrees is provided, this means that the lamp is included.
Bei Angabe der Grad in Kelvin ist die Lampe eingeschlossen.

LAMPHOLDER COLOUR CLASS COS φ CODE NOTES
 FASSUNG W ILCOS FARBE KLASSE KELVIN ≥ 0,9 EEI BESTELLNR. BEMERKNG. EURO



PLUS TONDO 350/G

E27	max 1x150w	IAA	WH1	I	•			007763
E27	max 1x150w	IAA	GR2	I	•			007764
E27	max 1x150w	IAA	AN2	I	•			007765
Discharge - magnetic ballast/Entladungslampe - VVG								
E27	max 1x70w	ME	WH1	I	•	•		007696
E27	max 1x70w	ME	GR2	I	•	•		007697
E27	max 1x70w	ME	AN2	I	•	•		007698
Fluorescent - electronic ballast 220/240V 50/60Hz/Leuchtstofflampen - EVG 220/240V 50/60Hz								
G24q-3	2x26w	FSQ	WH1	I	2700	•	A2	057787
G24q-3	2x26w	FSQ	GR2	I	2700	•	A2	057789
G24q-3	2x26w	FSQ	GR2	I	2700	•	A2	057788



IK06 1J xx3

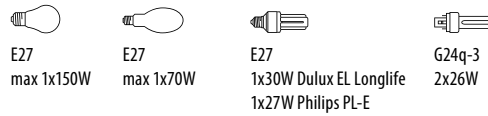
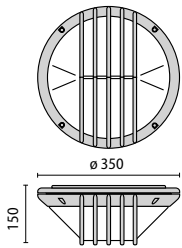

PLUS TONDO 350 VISA

E27	max 1x150w	IAA	WH1	I	•			007766
E27	max 1x150w	IAA	GR2	I	•			007767
E27	max 1x150w	IAA	AN2	I	•			007768
Discharge - magnetic ballast/Entladungslampe - VVG								
E27	max 1x70w	ME	WH1	I	•	•		007749
E27	max 1x70w	ME	GR2	I	•	•		007752
E27	max 1x70w	ME	AN2	I	•	•		007753
Fluorescent - electronic ballast 220/240V 50/60Hz/Leuchtstofflampen - EVG 220/240V 50/60Hz								
G24q-3	2x26w	FSQ	WH1	I	2700	•	A2	057790
G24q-3	2x26w	FSQ	GR2	I	2700	•	A2	057791
G24q-3	2x26w	FSQ	AN2	I	2700	•	A2	057792



IK06 1J xx3

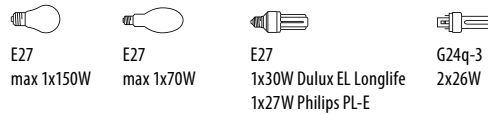
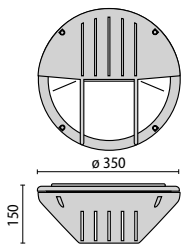

PACKAGE SIZE / VERPACKUNGSMASSE

40,5 x 38,5 x 76,5 cm (master x 4)

DISTANCE BETWEEN FIXING HOLES / BOHRLOCHABSTAND

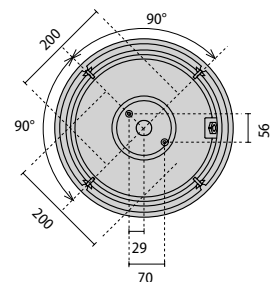

- WH1**
WHITE
WEISS
- GR2**
GLOSS METALLIC GREY
GRAU METALLIC, POLIERT
- AN2**
GLOSS METALLIC ANTHRACITE
ANTHRAZIT METALLIC,
POLIERT

IP 65

class I

IK06 1J xx3



PLUS TONDO 280 SPLIT

E27	max 1x100w	IAA	WH1	I	•	007654
E27	max 1x100w	IAA	GR2	I	•	007655
E27	max 1x100w	IAA	AN2	I	•	007656



Fluorescent - electronic ballast 220/240V 50/60Hz/Leuchtstofflampen - EVG 220/240V 50/60Hz

G24q-2	1x18w	FSQ	WH1	I	2700	A2÷A3	057654
G24q-2	1x18w	FSQ	GR2	I	2700	A2÷A3	057655
G24q-2	1x18w	FSQ	AN2	I	2700	A2÷A3	057656

IK06 1J xx3

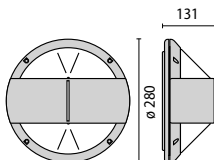

E27
max 1x100W



E27
1x14W Osram Dulux EL Facility
1x18W Philips PL-E



G24q-2
1x18W

PACKAGE SIZE / VERPACKUNGSMÄÙE

PLUS TONDO 280 SPLIT
32 x 32 x 58,5 cm
(master x 4)

DISTANCE BETWEEN FIXING HOLES / BOHRLOCHABSTAND

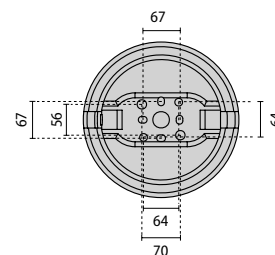

If information about Kelvin degrees is provided, this means that the lamp is included.
Bei Angabe der Grad in Kelvin ist die Lampe eingeschlossen.

PLUS

ACCESSORIES

280 D Post

350 D Post

Mini 350 D Post

Painted extruded aluminium posts suitable for single or twin (back to back) luminaire mounting, comprising:

- Self-extinguishing technopolymer junction box
- Painted die-cast aluminium flange for anchoring to the ground

280 M1 Post

350 M1 Post

Mini 350 M1 Post

- Painted extruded aluminium posts suitable for single luminaire only
- Die-cast aluminium bracket
- Self-extinguishing technopolymer junction box
- Painted die-cast aluminium flange for anchoring to the ground

280 M2 Post

350 M2 Post

Mini 350 M2 Post

- Painted extruded aluminium posts suitable for twin (back to back) luminaire mounting
- Brackets made from die-cast aluminium
- Self-extinguishing technopolymer junction box
- Painted die-cast aluminium flange for anchoring to the ground

Bracket 280

- Wall bracket 45°, made from die-cast aluminium suitable for single Plus 280 luminaire
- Supplied complete with plugs for wall mounting.

Bracket 350

- Wall bracket 45°, made from die-cast aluminium suitable for single Plus 350 luminaire
- Supplied complete with plugs for wall mounting.

ZUBEHÖR

Mast 280 D

Mast 350 D

Mast Mini 350 D

- Mast aus lackiertem eloxiertem Aluminium zur Aufnahme von einer Leuchte oder zwei Leuchten, bestehend aus:
 - Abzweigkasten aus selbstverlöschendem Technopolymer.
 - Flansch für die Bodenbefestigung aus lackiertem Aluminiumdruckguss.

Mast 280 M1

Mast 350 M1

Mast Mini 350 M1

- Maste aus lackiertem, eloxiertem Aluminium für eine Leuchte.
- Konsole aus Aluminiumdruckguss
- Abzweigkasten aus selbstverlöschendem Technopolymer.
- Flansch für die Bodenbefestigung aus lackiertem Aluminiumdruckguss.

Mast 280 M2

Mast 350 M2

Mast Mini 350 M2

- Maste aus lackiertem eloxiertem Aluminium für zwei Leuchten.
- Zwei Konsolen aus Aluminiumdruckguss
- Abzweigkasten aus selbstverlöschendem Technopolymer.
- Flansch für die Bodenbefestigung aus lackiertem Aluminiumdruckguss.

Wandkonsole 280

- Halterung aus Aluminiumdruckguss, 45° Neigung, für eine Leuchte PLUS 280.
- Dübel und Schrauben für die Wandbefestigung im Lieferumfang enthalten.

Wandkonsole 350

- Halterung aus Aluminiumdruckguss, 45° Neigung, für eine Leuchte PLUS 350.
- Dübel und Schrauben für die Wandbefestigung im Lieferumfang enthalten

DESCRIPTION / BESCHREIBUNG	COLOUR FARBE	CODE BESTELLNR.	EURO
Bracket 280/Socket 280	GR2	009340	
Bracket 280/Socket 280	AN2	002439	
Bracket 350/Socket 350	GR2	009348	
Bracket 350/Socket 350	AN2	002440	
Post 280 D/Mast 280 D	GR2	009337	
Post 280 D/Mast 280 D	AN2	002430	
Post 280 M1/Mast 280 M1	GR2	009338	
Post 280 M1/Mast 280 M1	AN2	002431	
Post 280 M2/Mast 280 M2	GR2	009339	
Post 280 M2/Mast 280 M2	AN2	002432	
Post 350 D/Mast 350 D	GR2	009343	
Post 350 D/Mast 350 D	AN2	002436	
Post 350 M1/Mast 350 M1	GR2	009345	
Post 350 M1/Mast 350 M1	AN2	002437	
Post 350 M2/Mast 350 M2	GR2	009347	
Post 350 M2/Mast 350 M2	AN2	002438	
Post 350 mini D/Mast 350 mini D	GR2	009342	
Post 350 mini D/Mast 350 mini D	AN2	002433	
Post 350 mini M1/Mast 350 mini M1	GR2	009344	
Post 350 mini M1/Mast 350 mini M1	AN2	002434	
Post 350 mini M2/Mast 350 mini M2	GR2	009346	
Post 350 mini M2/Mast 350 mini M2	AN2	002435	

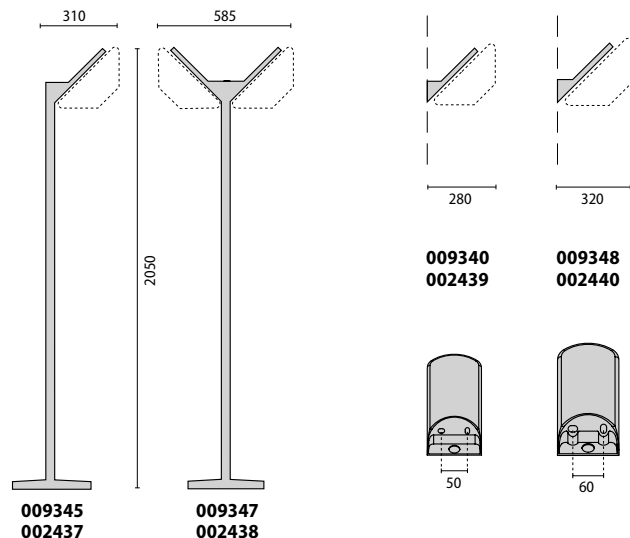
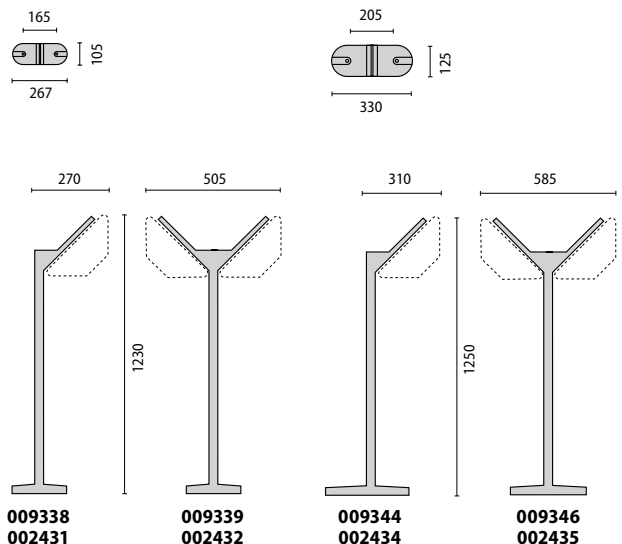
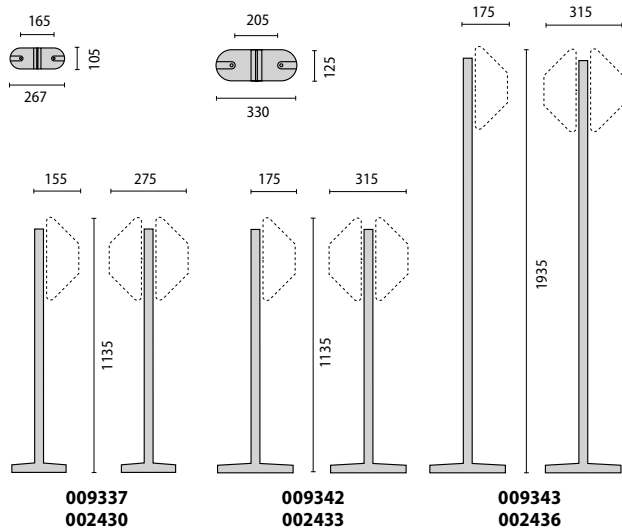

- WH1** WHITE WEISS
- GR2** GLOSS METALLIC GREY GRAU METALLIC, POLIERT
- AN2** GLOSS METALLIC ANTHRACITE ANTHRIZIT METALLIC, POLIERT