

Polo



Features IP65

- Accent floodlight.
- Body and power supply housing is made of die cast aluminium, toughened safety glass, weatherproof durable silicone gasket with external screws made of stainless steel.
- Superior polyester powder paint resistant to outdoor atmospheric conditions.
- Front cover is designed to avoid accumulation of dust and water.
- Light source include adjustability along the vertical and horizontal axis.
- Fixture is available in 3 different sizes.
- Easy relamping via Allen screws.
- PG7 cable entry.
- Light source include Halogen, Metal Halide and LED.
- Long life LED light source provide IR and UV free emission.
- LED optics use collimating lens made of optical polymer for different beam optics.
- Designed and manufactured to comply with European standard EN 60598.

Applications

- Polo with the range of accessories can be mounted on the ground and wall. The visor glare shield cap or the protective grill help to protect the environment from unpleasant bright light. The earth spike is for portable or temporary use.
- Application areas: to highlight trees, plants, bushes, landscapes, gardens, golf courses, canopies, small roads, illuminate signboards, sculptures architectural element enhancement.



Colour 10 29

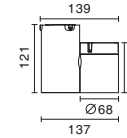

Polo

3138 20W GX10 MR16 M.H.
With integral electronic control gear 220-240V 50/60Hz.

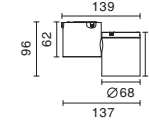

Polo

3136 35W GU5.3 MR16 Hal.
With integral electronic transformer 220-240/12V 50/60Hz.

3137 35W GU10/GZ10 Hal.

3171-RGB With 3x3W LED RGB **LED**

Inclusive of remote DMX LED driver and power supply integrated inside IP67 thermoplastic case, 9W 100-240V 50/60Hz with Signal In/Out cable connectors for multiple connection.
Supplied with 500mm long hard wire PVC+PVC B 6x0.5mm² to connect the remote driver to the fixture.
Requires DMX switchboard to control color scenes, Art. 2975, to be ordered separately.

3510-K30D16	With 10W LED 3000K 500lm	16°	LED
3510-K40D16	With 10W LED 4000K 600lm	16°	
3510-K30D26	With 10W LED 3000K 500lm	26°	
3510-K40D26	With 10W LED 4000K 600lm	26°	
3510-K30D44	With 10W LED 3000K 500lm	44°	
3510-K40D44	With 10W LED 4000K 600lm	44°	

Passive dissipation, inclusive of integral driver 220-240V 50/60Hz. CRI>80.
Other colour temperatures K or CRI are available upon request.

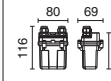

IP67 Control Unit Box included with Art. 3171-RGB

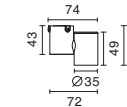

Micro Polo

3139-K30D15 With 3W LED 3000K 65lm 15° **LED**

3139-K63D15 With 3W LED 6300K 80lm 15°
Passive dissipation, inclusive of integral driver 220-240V 50/60Hz. CRI>80.
Other colour temperatures K or CRI are available upon request.

Accessories



2375 Protective Grill for Polo
In die cast aluminium.
Available in colours 10, 29.



2372 Spike for Polo H: 223

2373 Spike for Micro Polo H: 223
In plastic.
The 50mm upper part must stay above ground level according to standards.
Available in colour 10.



2378 Visor for Polo
In die cast aluminium.
Available in colours 10, 29.



2975 DMX Switchboard
Power supply: 110-240V 50/60Hz.
Installation: Plastic recessing box included.
IP40.
Control signal: DMX512.
Control channel: 60 channels.
Dimension: 116 x 120 x 72 mm.
For details, please see p.426.