

# SlimLine



## Related products:



**SLIM & SLICK**  
P.222-223

## Features

IP20

- Seamless lighting luminaires for individual or continuous row mounting.
- Body made of Aluminium, low brightness controlled diffuser made of Polycarbonate.
- Electronic control gear for flicker free and soft start is integrated.
- Seamless lighting without black spots.
- Available in 4 different lengths, utilize either fluorescent T5 FHE or FHO for a choice of higher light intensity.
- Linkable up to max.600W from one power supply. The information for max number of fixtures is listed.
- Dimmable versions are available and listed with full control specifications & compatibility.
- Can be boosted to increase total units.
- Simple installation system to reduce installation time.
- Easy relamping by tool-free.
- Accessories to be ordered separately for versatility with numerous feed options.
- Designed and manufactured to comply with European standard EN 60598.
- Approvals: UL Listed, TUV.

## Applications

- Slimline is a seamless lighting system for continuous line of unbroken light without any dark spots and available in dimmable versions. It has been designed and engineered to provide the highest performance with maximum flexibility for most lighting applications.
- Application areas: under shelf display, cove lighting, museum, gallery, office, retail.



Colour 11

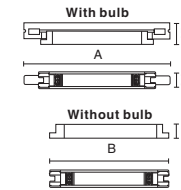

Max. Linkage	14W	21W	24W	28W	35W	39W	54W
600W or	42pcs	28pcs	25pcs	21pcs	17pcs	15pcs	11pcs

With Art. 2356.

## SlimLine

<b>4027</b>	14W	G5	SLS		A: 580	B: 500
<b>4028</b>	21W	G5	SLS		A: 880	B: 800
<b>4029</b>	28W	G5	SLS		A:1180	B:1100
<b>4048</b>	35W	G5	SLS		A:1400	B:1320
<b>4015</b>	24W	G5	SLS		A: 580	B: 500
<b>4016</b>	39W	G5	SLS		A: 880	B: 800
<b>4017</b>	54W	G5	SLS		A:1180	B:1100

SLS lamp included.  
With integral electronic control gear 220-240V 50/60Hz.

For the available accessories: please see p.226-227.

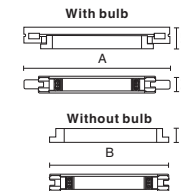

## DimSlimLine

<b>4030</b>	14W	G5	SLS		A: 580	B: 500
<b>4031</b>	21W	G5	SLS		A: 880	B: 800
<b>4032</b>	28W	G5	SLS		A:1180	B:1100
<b>4053</b>	35W	G5	SLS		A:1400	B:1320
<b>4035</b>	24W	G5	SLS		A: 580	B: 500
<b>4036</b>	39W	G5	SLS		A: 880	B: 800
<b>4037</b>	54W	G5	SLS		A:1180	B:1100

SLS lamp included.  
Protocol: PWM.  
With integral electronic control gear 220-240V 50/60Hz.  
For max. linkage, please refer to dimming controllers/ translators at following pages.

For the available accessories: please see p.226-227.

## Installation Guide for DimSlim and SlimLine

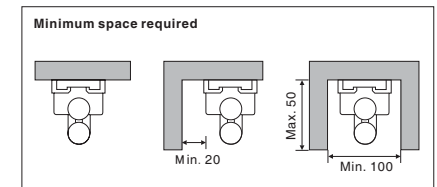
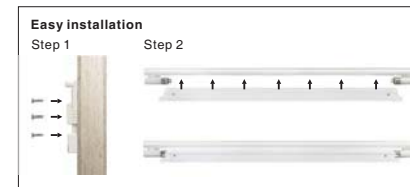

## Dimming effect



5%

50%

100%

Accessories



**2059 Direct Connector**  
For SlimLamp



**2228 Direct Connector**  
For DimSlim



**2296 Direct Connector**  
For SlimLine and DimSlimLine



**2061 Flexible Connector** L: 150

**2185 Flexible Connector** L: 300

**2186 Flexible Connector** L: 600

**2187 Flexible Connector** L:1200

**2188 Flexible Connector** L:1800  
For SlimLamp



**2223 Flexible Connector** L: 150

**2224 Flexible Connector** L: 300

**2225 Flexible Connector** L: 600

**2226 Flexible Connector** L:1200

**2227 Flexible Connector** L:1800  
For DimSlim



**2585 Flexible Connector** L: 150

**2358 Flexible Connector** L: 300

**2501 Flexible Connector** L: 600

**2502 Flexible Connector** L:1200

**2503 Flexible Connector** L:1800  
For SlimLine and DimSlimLine



**2222 Power Cord**  
Length: 1800mm.  
Between Dimming Controller and DimSlim.  
RoHS CE



**2060 Power Cord**  
With plug.  
Length: 1800mm.  
For SlimLamp.



**2356 Power Cord**  
Without plug.  
Length 1800mm.  
Between mains and Slimline or between Dimming Controller and DimSlimLine.



**2586 Vertical Power Cord**  
Without plug.  
Length: 1800mm.  
Between mains and Slimline or between Dimming Controller and DimSlimLine.



**2587 Horizontal Power Cord**  
Without plug.  
Length: 1800mm.  
Between mains and Slimline or between Dimming Controller and DimSlimLine.



**2297 Protecting Cap**  
End cap for SlimLine and DimSlimLine

Accessories



**2220 Dimming Controller (Brightness)**  
1 channel, 2 output terminal block (2x3 pin).  
Input voltage: 90-240V 50/60Hz.  
Signal output: PWM.  
Max. connection: 10 pcs of DimSlim/ DimSlimLine per terminal block and up to 400W regardless of output terminal block.  
Control range: 1-14 levels of intensity.  
Dimensions: 70 x 120 x d38 mm.



**2580 Dimming Controller (Brightness & Mood)**  
2 channels.  
Input voltage: 90-240V 50/60Hz.  
Signal output: PWM.  
Max. Connection: 10 pcs of DimSlim/ DimSlimLine/ LED dimming products per channel and up to 350W per channel .  
Control range: 4 scenes memorized.  
Dimensions: 70 x 122 x d45 mm.



**2246 ON/OFF Switch**  
Inline switch.  
For SlimLamp.  
Can be connected to mains via Art. 2060 and to SlimLamp via Art. 2059.  
Dimensions: 120 x 23 x h33 mm.



**2588 Dimming Controller Back Boxes**  
Metal box for recessing into walls.  
For Art. 2220.  
Dimensions: 53 x 102 x d44 mm.



**2307 Booster**  
Input power: 90-240V 50/60Hz.  
Art. 2220 & Art. 2580 are able to connect maximum 10pcs of DimSlim/ DimSlimLine per channel, while booster Art. 2307 remarkably extends connecting capability. Link Booster at the 10th DimSlim/ DimSlimLine from Art. 2220 or Art. 2580 and then 20pcs more fixtures can be connected.  
Dimensions: 122 x 44 x h23 mm.



**2306 DALI/DSI/DMX to DimSlim PWM Translator**  
Interface DimSlim/ DimSlimLine PWM with any other DALI/DSI/DMX manufactured control proprietary system.  
Input voltage: 198-264V 50/60Hz.  
Current: 20amp - 4mm<sup>2</sup> terminals.  
A single translator can handle a total of 3,500 lamp watts.  
4 independent PWM output signals for DimSlim/ DimSlimLine.  
Maximum connecting load for individual output is 10 amps/1750 lamp watts per circuit, or 50 fixtures per channel.  
Mechanical fixing: DIN rail clip lock.  
Dimensions: 209 x 86 x d66 mm.



**2309 0-10V/1-10V to PWM Translator**  
2 channels.  
Input voltage: 220-240V 50/60Hz.  
Signal input: 0-10V/1-10V DC.  
Signal output: PWM.  
Max. connection: 10 pcs of DimSlim/ DimSlimLine/ LED dimming products per channel and up to 400W per channel.  
Dimensions: 140 x 58 x h35 mm.